

BH U 槽 配 件

BH U-Channel Parts



Standard Dimension

The dimension shown applies to all fittings except specifically noted on the part drawing. All dimensions are subjected to commercial tolerances.

Finishes

Standard finish hot-dip galvanized or zinc electroplated as appropriate. Other finishing available to order. Ex: Stainless steel 316 or 304, pre-galvanized etc...



Dimension

BEST HONOR ELECTRICAL LIMITED

信譽電器有限公司

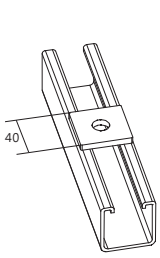

BH-SP001

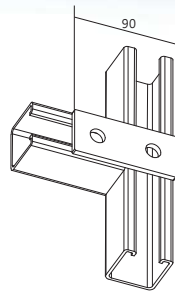

BH-2H.C.P.

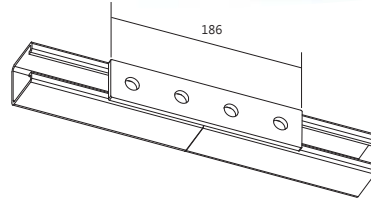

BH-4H.C.P.

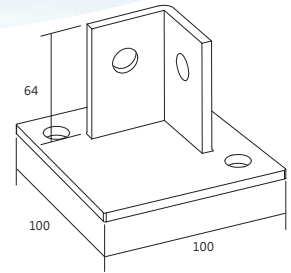

BH-S.B.P.

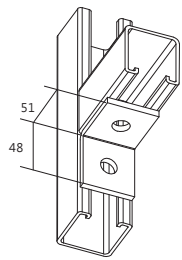

BH-2H.A.B.

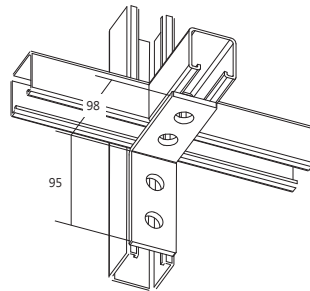

BH-4H.A.B.

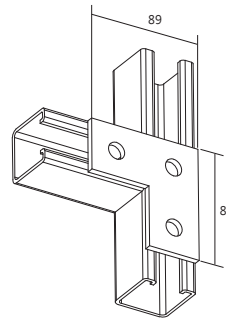

BH-3H.L.C.P.

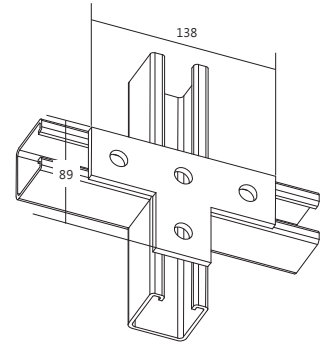

BH-4H.T.C.P.

Model	Hole Size	Width	Thickness	Connection Hole	Shape	Pcs / pack
BH-SP001	Ø14mm	40mm	3mm	1 Hole	Square	1 / 300
BH-2H.C.P.			5mm	2 Hole	Strip	1 / 150
BH-4H.C.P.			5mm	4 Hole	Strip	1 / 60
BH-2H.A.B.			5mm	2 Hole	Angle Bracket	1 / 150
BH-4H.A.B.			5mm	4 Hole	Angle Bracket	1 / 75
BH-S.B.P.			6mm	4 Hole	Single Base	1 / 12
BH-3H.L.C.P.			5mm	3 Hole	L shape	1 / 25
BH-4H.T.C.P.			5mm	4 Hole	T shape	1 / 25

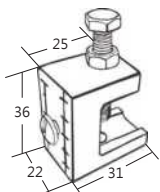

BH-BC/M6

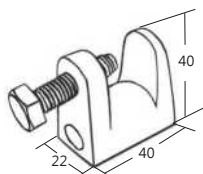

BH-BC/M8

Model	Dimension (LxWxD) mm	Opening	Type	Pcs / pack
BH-BC/M6	36 x 31/25 x 22	20	Beam Clamp	10 / 50
BH-BC/M8	40 x 40 x 22			



BH-LSN/M6

c/w
M6x25
Screw



BH-LSN/M10

c/w
M10x25
Screw

Model	Dimension (LxWxD) mm	Type	Pcs / pack
BH-LSN/M6	35 x 19 x 5	Long Spring Nut	10 / 50
BH-LSN/M10			

